



## 3,200 SF 2ND GENERATION RESTAURANT SPACE WITH PATIO | FOR LEASE

12640 Bartram Park Blvd, #5  
Jacksonville, FL 32258

SEAN MCGILL  
D - 904.302.6943  
[sean@cantrellmorgan.com](mailto:sean@cantrellmorgan.com)





# PROPERTY OVERVIEW

## PROPERTY HIGHLIGHTS

- 12640 Bartram Park Blvd, #5
- Approximately 3,200 SF
- Built in 2006
- Fully built out kitchen
- 61 parking spaces
- Patio space
- Located in the heart of Bartram Park

## DEMOGRAPHICS

	3 MILES	5 MILES
Population	50,796	135,132
Households	19,872	52,191
Median Age	37.5	38.9
Median Household Income	\$101,883	\$106,846
Average Household Income	\$138,461	\$139,466

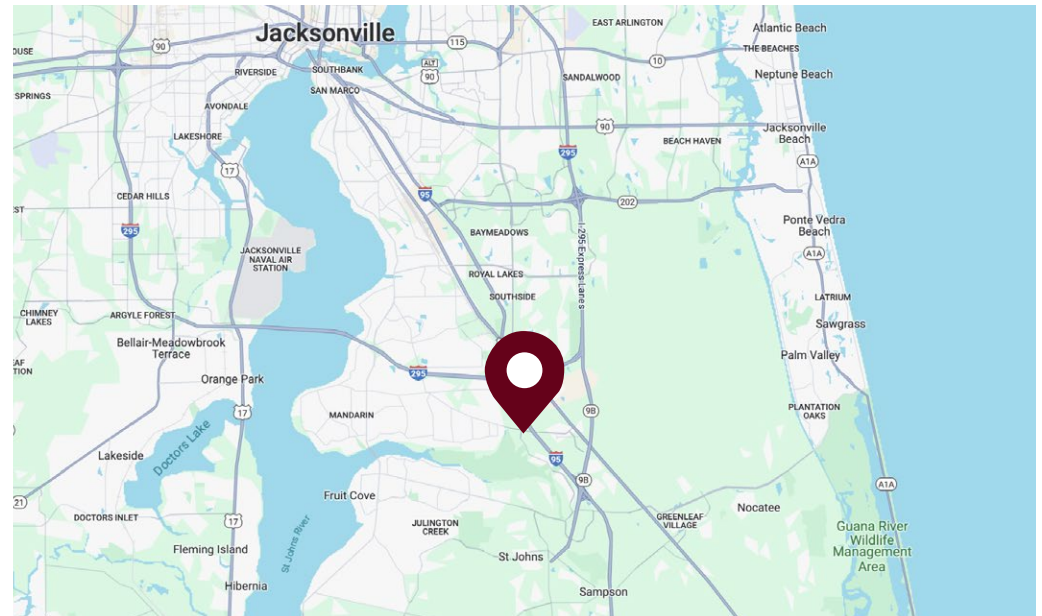

12640 Bartram Park Blvd, #5 | Jacksonville, FL 32258

SEAN MCGILL  
D - 904.302.6943  
sean@cantrellmorgan.com





# SURROUNDING AREA



12640 Bartram Park Blvd, #5 | Jacksonville, FL 32258

SEAN MCGILL  
D - 904.302.6943  
sean@cantrellmorgan.com





## SURROUNDING AREA



12640 Bartram Park Blvd, #5 | Jacksonville, FL 32258

SEAN MCGILL  
D - 904.302.6943  
sean@cantrellmorgan.com





# SURROUNDING AREA



12640 Bartram Park Blvd, #5 | Jacksonville, FL 32258

SEAN MCGILL  
D - 904.302.6943  
sean@cantrellmorgan.com





# SITE PLAN

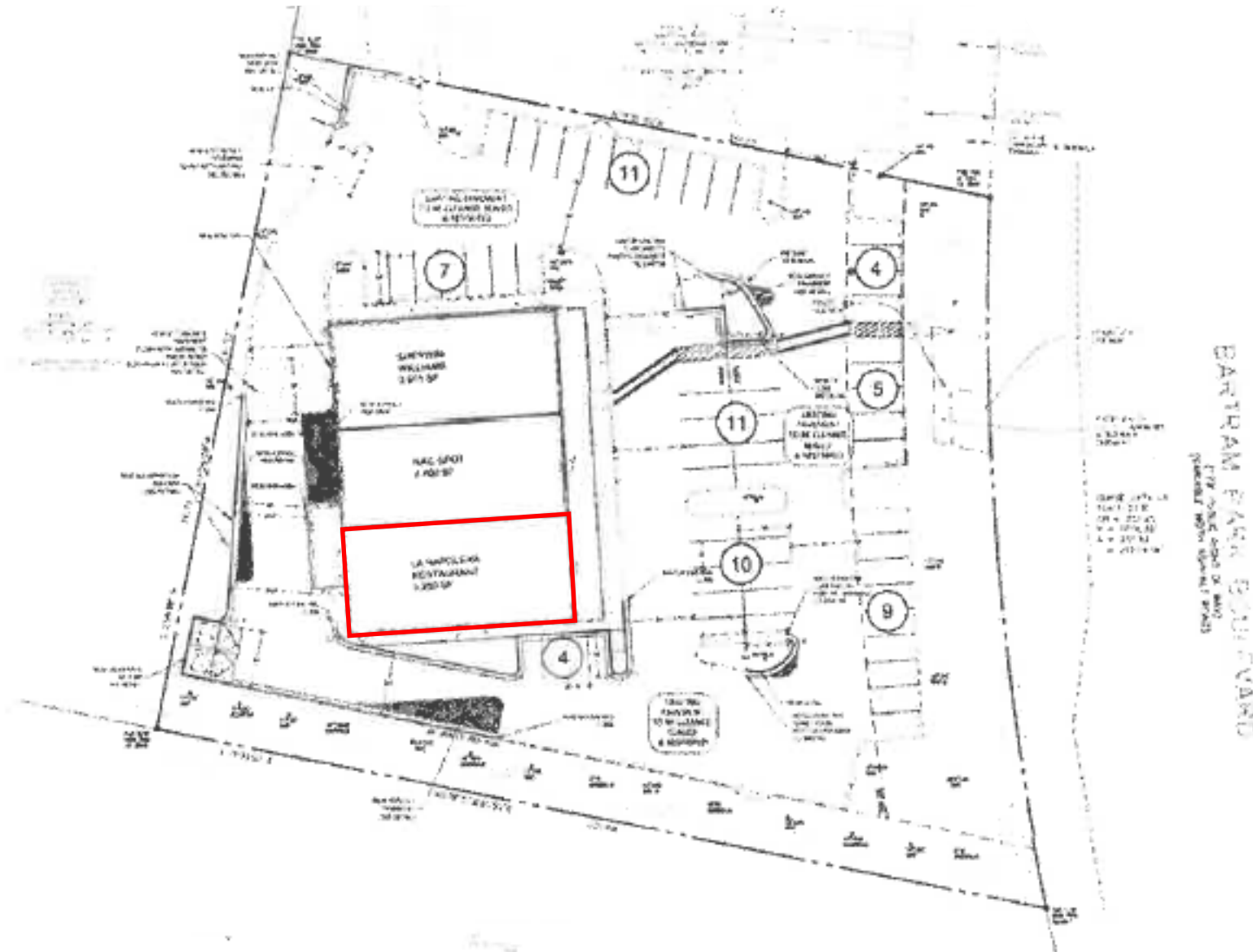

12640 Bartram Park Blvd, #5 | Jacksonville, FL 32258

SEAN MCGILL  
D - 904.302.6943  
sean@cantrellmorgan.com



# FLOOR PLAN

